

ADDENDUM:

2

TODAY'S DATE:

04.27.23

PROJECT NAME: Nike Manor Roof

CONTACT / TITLE: Amy Kurtz

PROJECT MANAGER

PHONE / EMAIL: 206-574-1283

AmyK@kcha.org

This Addendum is used to Identify Items in the Original Documents with Action as Follows:

☒ **BID**

☐ **RFQ**

☐ **RFP**

☒ **CLARIFY**

☒ **CHANGE**

☒ **DELETE**

☐ **ADD**

☒ **SUBSTITUTE**

2 **Page(s) Total for this Addenda including this page.**

DELETE

1. Remove Building #27 (3535) roof from bid due to fire.

SUBSTITUTION:

1. Sikaplan fully adhered PVC roof system will not be accepted as a substitution. All roofing products will be TPO.

QUESTIONS:

1. **QUESTION:** Is this project under regular State Prevailing Wage or Davis Bacon Wages?
ANSWER: The Project is Washington State Prevailing Wage.
2. **QUESTION:** I noticed plywood will be installed at the overhang section at the garage cut back. Is this the only section we will need plywood?
ANSWER: The base bid will include the removal and replacement of five (5) sheets of ½" plywood per building.
3. **QUESTION:** Do the metal soffits get replaced?
ANSWER: The Metal soffits will be removed and will not be replaced.

END OF ADDENDA # 2



Nike Manor
23960 35th Pl S
Kent, WA 98032

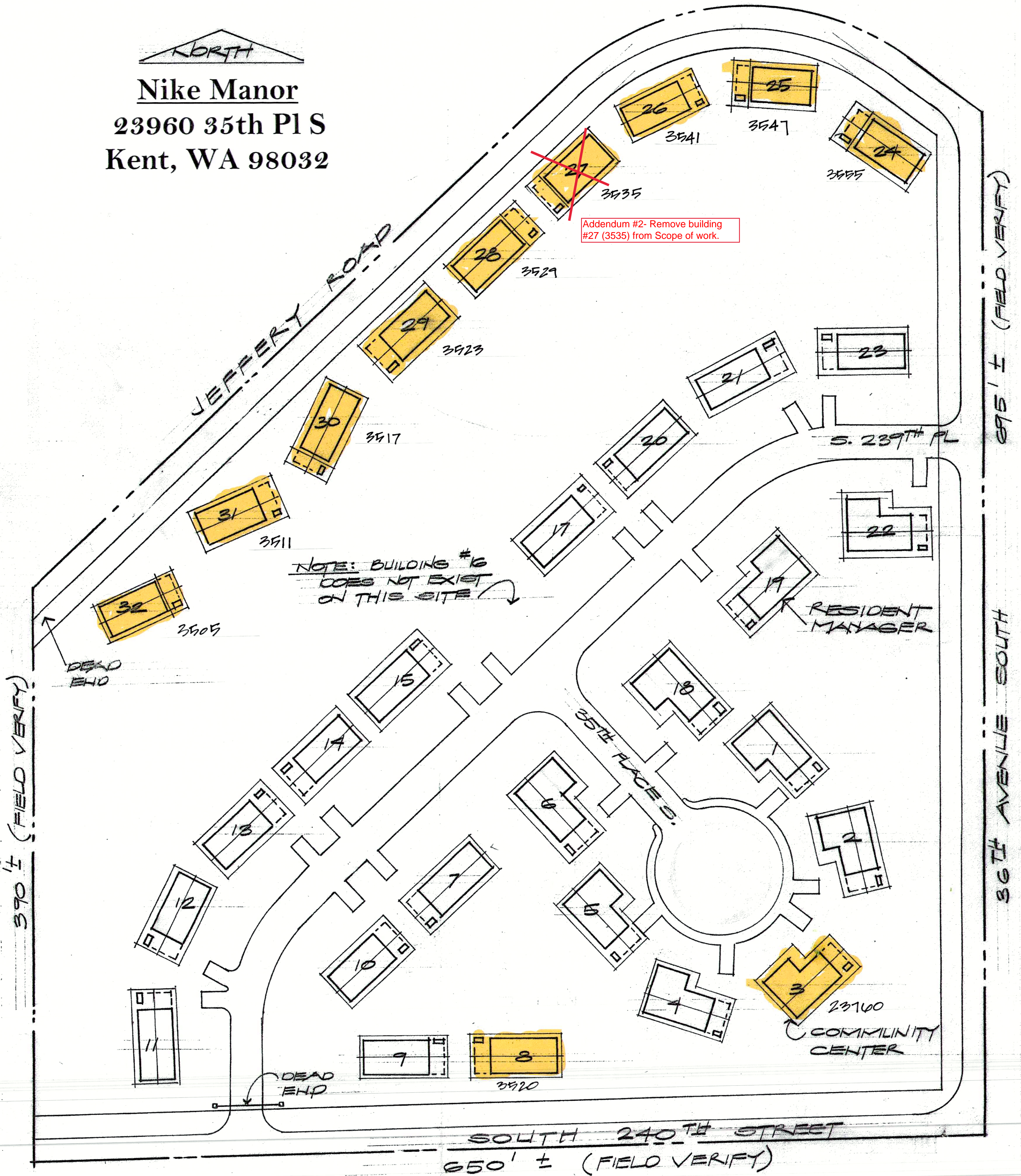

SITE PLAN
SCALE: 1" = 50'